

# Manualne z trawersami 2

## 5552

**Maximum lacquered detail:** W1000 D2900mm

**Hall dimensions:** 12,950 x 4,500mm

**Drying after surface preparation and polymerization:** 1 zone oven-dryer

**Manual painting:** Cab open

**Transport system:** Manual upper TR

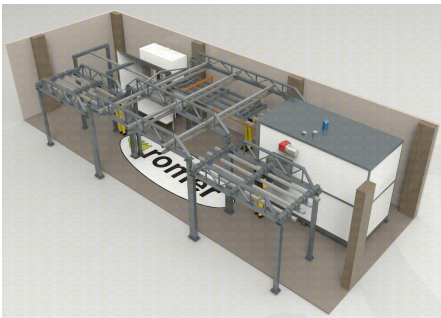
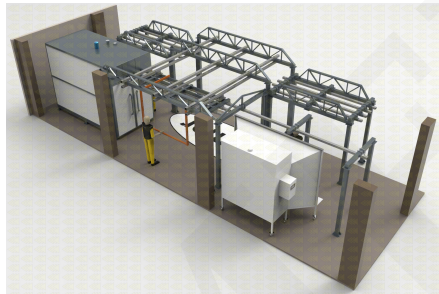
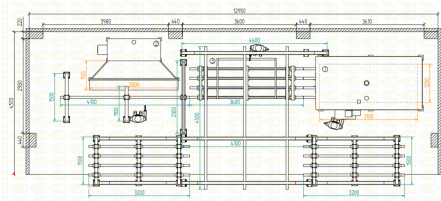

## 4320

**Maximum lacquered detail:** W1800 D7300mm

**Hall dimensions:** 16,240x16,640mm

**Drying after surface preparation and polymerization:** 1 zone oven-dryer

**Manual painting:** Cab open

**Transport system:** Manual upper TR

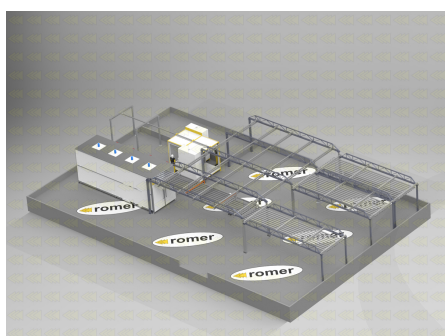
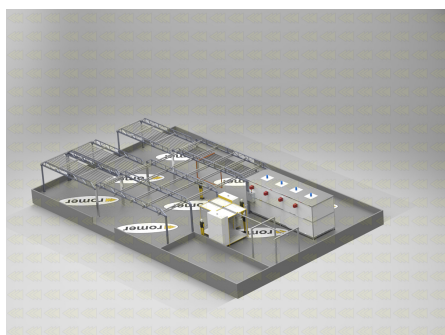
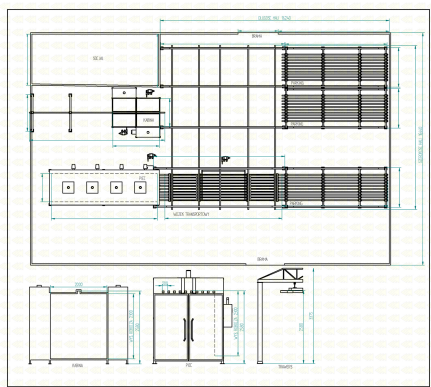

## 4120-1

**Maximum lacquered detail:** W1800 D7800mm

**Hall dimensions:** 60,000x40,000mm

**Surface preparation:** 2-stage automatic car wash

**Drying after surface preparation:** 6 zone dryer

**Manual painting:** Pass-through tunnel cabin KPT1

**Polymerization:** 6 zone oven

**Transport system:** Manual Top

## ROMER - Producent wysokiej jakości lakierni proszkowych

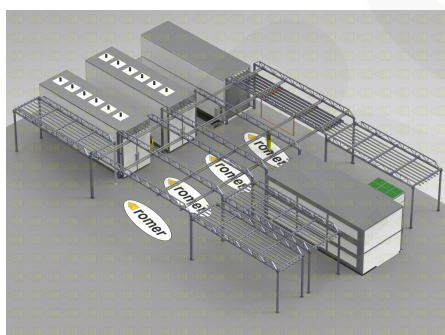
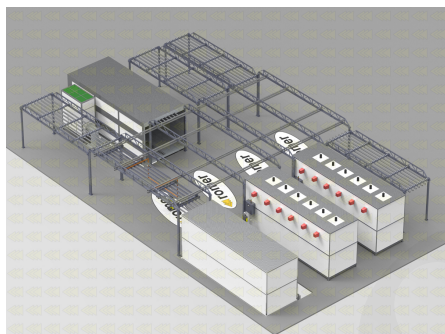
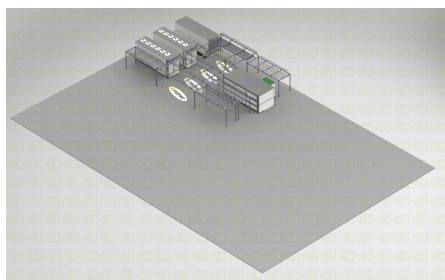
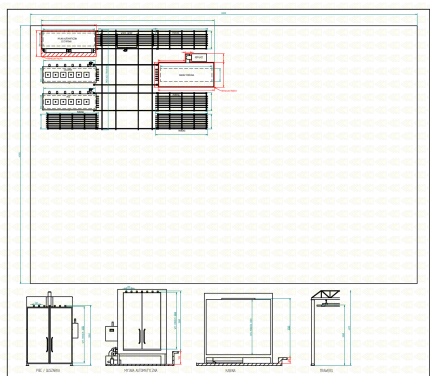

### 4120-2

**Maximum lacquered detail:** W1800 D7800mm

**Hall dimensions:** 60,000x40,000mm

**Surface preparation:** 2-stage automatic car wash

**Drying after surface preparation:** 6 zone dryer

**Manual painting:** Pass-through tunnel cabin KPT1

**Polymerization:** 6 zone oven

**Transport system: Manual Top**

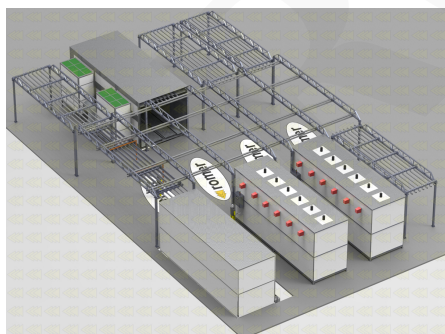
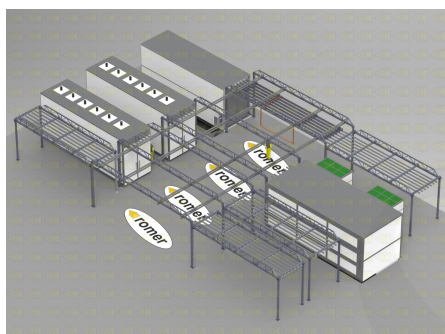
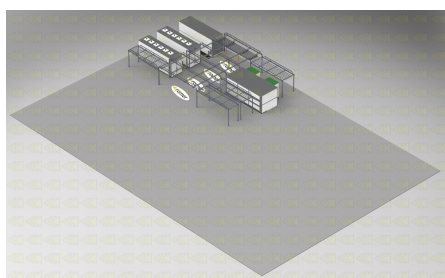
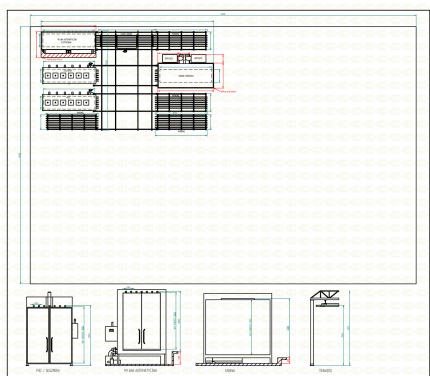

## 9994

**Maximum lacquered detail:** W1800 D7800mm

**Hall dimensions:** 25,000x24,800mm

**Surface preparation:** 2-stage automatic car wash

**Drying after surface preparation and polymerization:** 2 zone oven-dryer

**Manual painting:** Pass-through tunnel cabin KPT1



**Transport system: Manual Top**

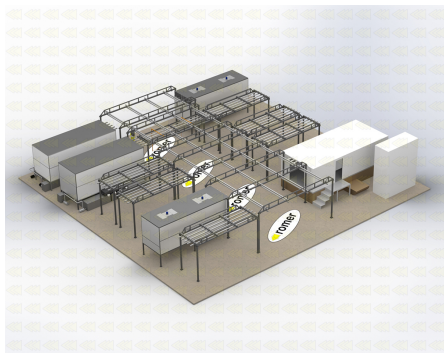
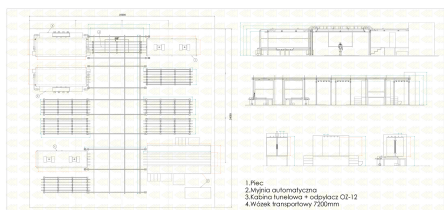

ROMER