

Hybridní poloautomat

6585

Maximum lacquered detail: W1000 D7300mm

Hall dimensions: 33,500 x 16,600mm

Surface preparation: Automatic 5-stage car wash with drying MA1-4

two-station pass-through cabin Drying after surface preparation: Wash drying MA1-4

4 zone oven Manual painting: KPD-2

Automatic painting:Plastic cabin with gates in two axes for quick color changes KAP-1

Polymerization: SL/SW

Transport system: Manual upper TR

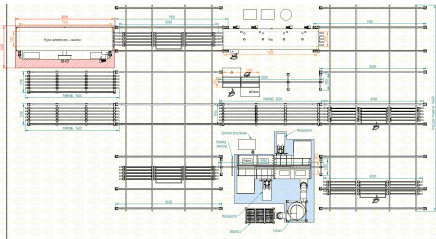

7215

Maximum lacquered detail: W1000 D6800mm

Hall dimensions: 31,500x17,000mm

Surface preparation (Aluminium): Automatic 5-stage car wash with drying MA1-4

Surface preparation (Steel): Automatic 3-stage car wash with drying MA1-3

Drying after surface preparation: 4 zone oven SL/SW

Automatic painting:Plastic cabin with gates in two axes for quick color changes KAP-1

Polymerization: SL/SW

4 zone oven Transport system: Manual upper TR

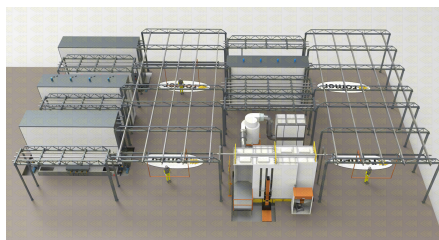
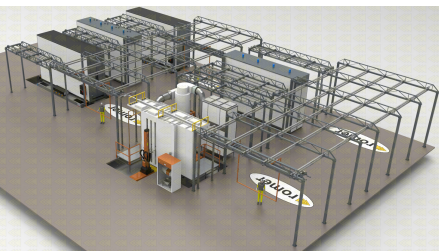
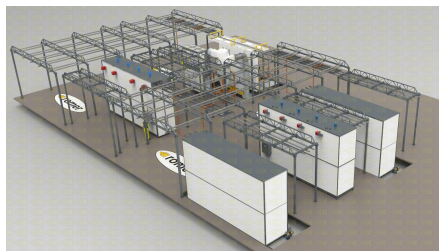
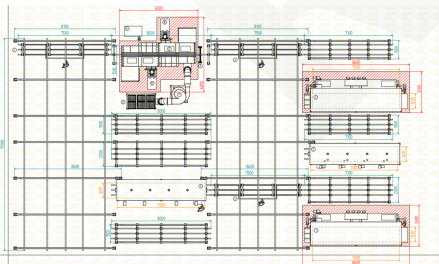

7085

Maximum lacquered detail: W1000 D4200mm

Hall dimensions: 33,700 x 18,900mm

two-station pass-through cabin Surface preparation (Aluminium): Automatic 5-stage car wash with MA1-5

Surface preparation (Steel): drying Automatic 3-stage car wash with drying MA1-3

Drying after surface preparation: 2 zone oven SL / SW

2 zone oven Manual painting: KPD-2

Automatic painting: Plastic cabin with gates in two axes for quick color changes KAP-1

Polymerization: SL / SW

Transport system: Manual upper TR

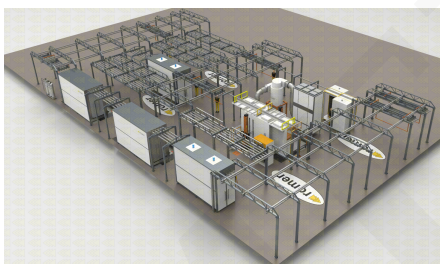
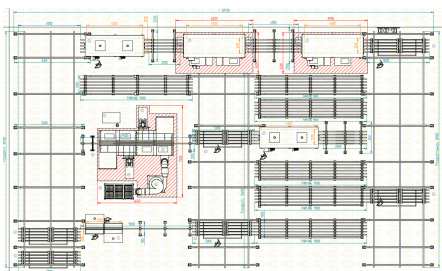

4030

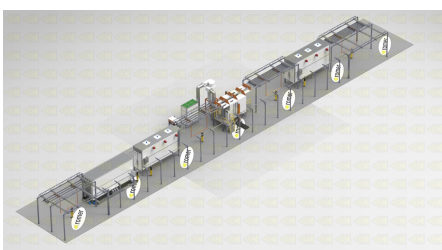
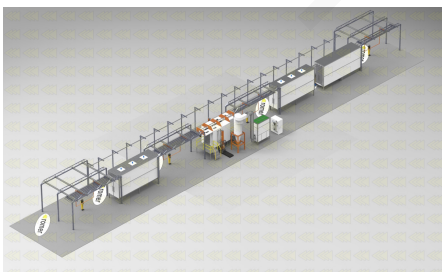
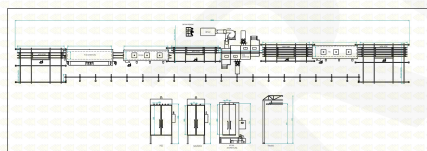

8790

