

Manualne z trawersami 2

5552

Maximaal gelakte detail: B1000 D2900mm

Afmetingen hal: 12.950 x 4.500 mm

Drogen na oppervlaktevoorbereiding en polymerisatie: Oven-droger met 1 zone

Handmatig schilderen: Cabine open

Transportsysteem: Handmatige bovenste TR

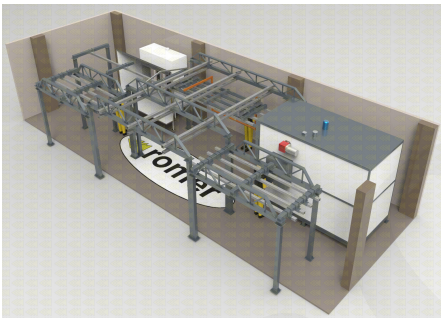
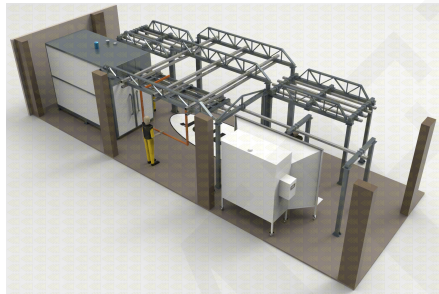
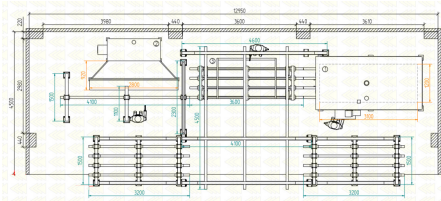

4320

Maximaal gelakte detail: B1800 D7300mm

Afmetingen hal: 16.240x16.640mm

Drogen na oppervlaktevoorbereiding en polymerisatie: Oven-droger met 1 zone

Handmatig schilderen: Cabine open

Transportsysteem: Handmatige bovenste TR

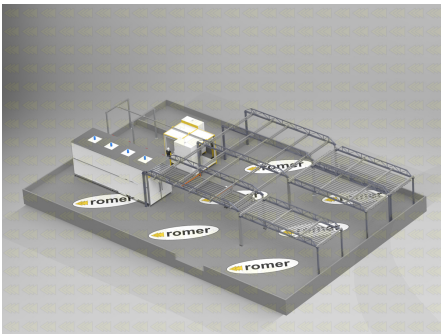
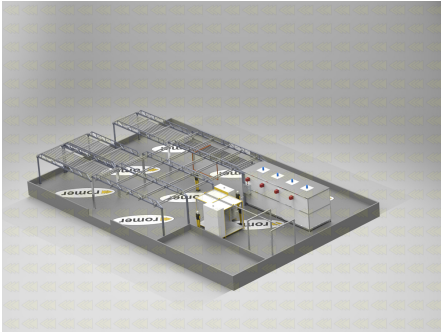
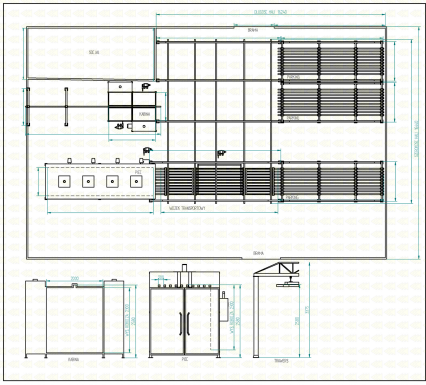

4120-1

Maximaal gelakte detail: B1800 D7800mm

Afmetingen hal: 60.000x40.000mm

Oppervlaktevoorbereiding: Automatische wasstraat in 2 fasen

Drogen na voorbereiding van het oppervlak: Droger met 6 zones

Handmatig schilderen: Doorgangstunnelcabine KPT1

Polymerisatie: Oven met 6 zones

Transportsysteem: Handleiding Boven

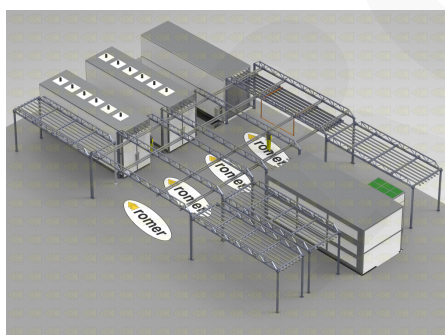
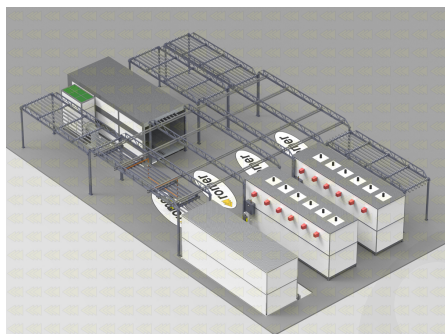
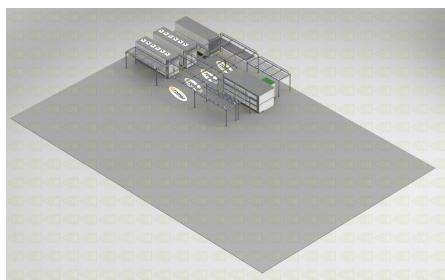
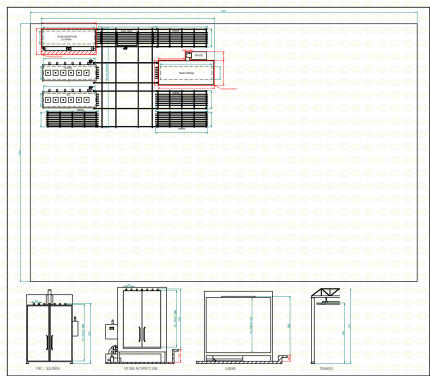

4120-2

Maximaal gelakte detail: B1800 D7800mm

Afmetingen hal: 60.000x40.000mm

Oppervlaktevoorbereiding: Automatische wasstraat in 2 fasen

Drogen na voorbereiding van het oppervlak: Droger met 6 zones

Handmatig schilderen: Doorgangstunnelcabine KPT1

Polymerisatie: Oven met 6 zones

Transportsysteem: Handleiding Boven

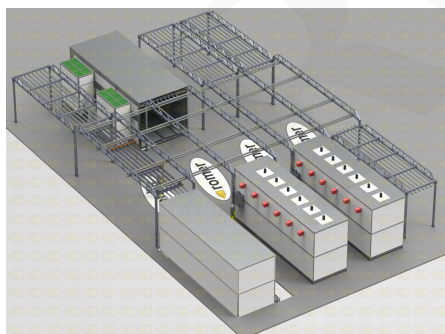
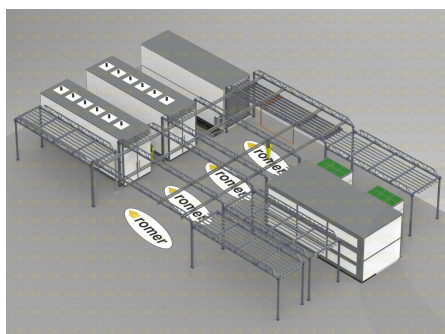
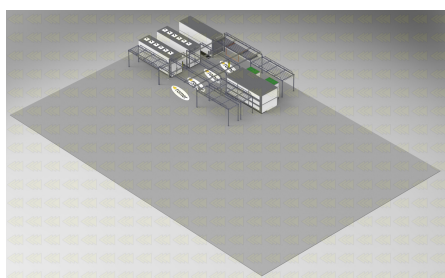
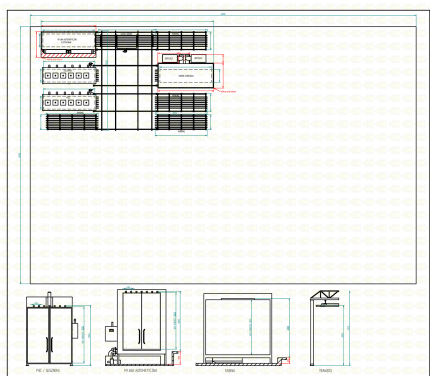

9994

Maximaal gelakte detail: B1800 D7800mm

Afmetingen hal: 25.000x24.800mm

Oppervlaktevoorbereiding: Automatische wasstraat in 2 fasen

Drogen na oppervlaktevoorbereiding en polymerisatie: Oven-droger met 2 zones

Handmatig schilderen: Doorgangstunnelcabine KPT1

ROMER - Producent wysokiej jakości lakierni proszkowych

Transportsystem: Handleiding Boven

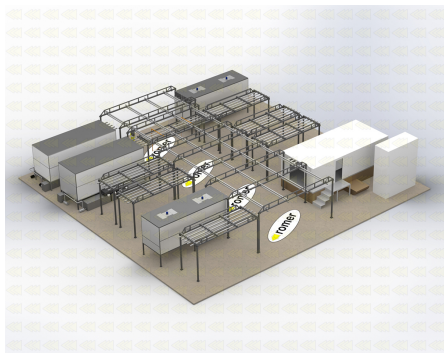
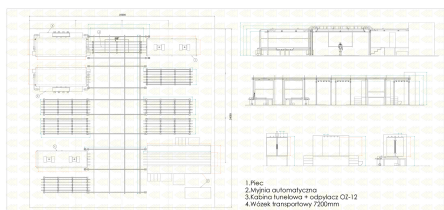

ROMER