

# Manualne z trawersami 2

## 5552

**Maksimal lakkert detalj:** B1000 D2900mm

**Hallmål:** 12 950 x 4 500 mm

**Tørking etter overflatebehandling og polymerisering:** 1 sone ovn-tørker

**Manuell maling:** Drosje åpen

**Transportsystem:** Manuell øvre TR

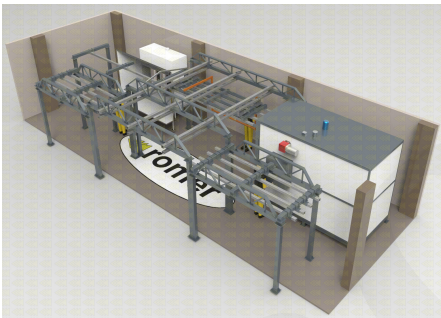
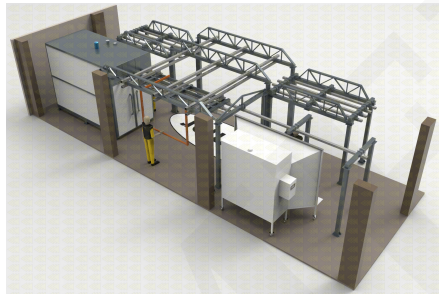
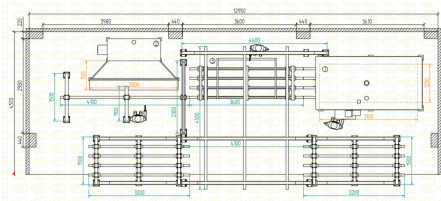

## 4320

**Maksimal lakkert detalj:** W1800 D7300mm

**Hallmål:** 16 240 x 16 640 mm

**Tørking etter overflatebehandling og polymerisering:** 1 sone ovn-tørker

**Manuell maling:** Drosje åpen

**Transportsystem:** Manuell øvre TR

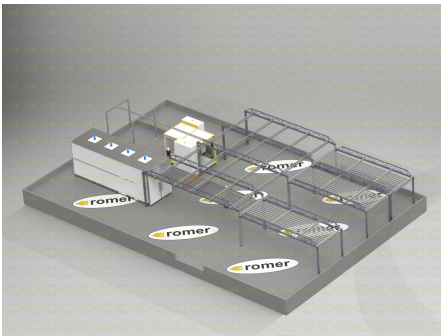
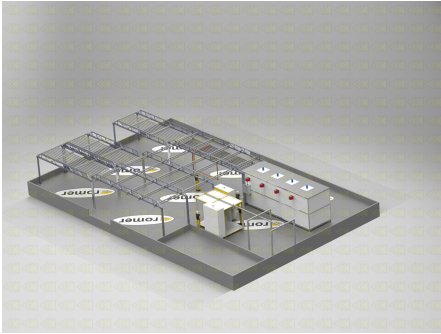
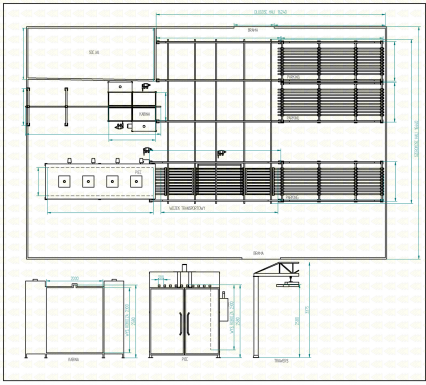

## 4120-1

**Maksimal lakkert detalj:** W1800 D7800mm

**Hallmål:** 60 000 x 40 000 mm

**Overflateforbehandling:** 2-trinns automatisk bilvask

**Tørking etter overflatebehandling:** 6-soners tørketrommel

**Manuell maling:** Gjennomgående tunnelhytte KPT1

**Polymerisasjon:** 6-soners ovn

**Transportsystem:** Manuell Topp

## ROMER - Producent wysokiej jakości lakierni proszkowych

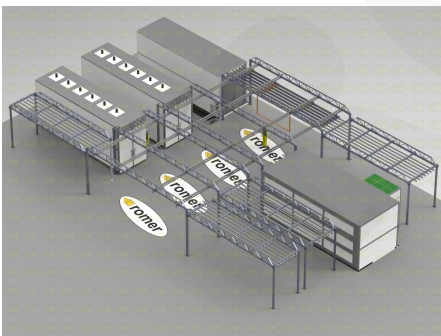
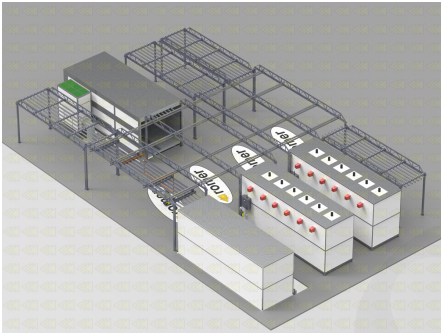
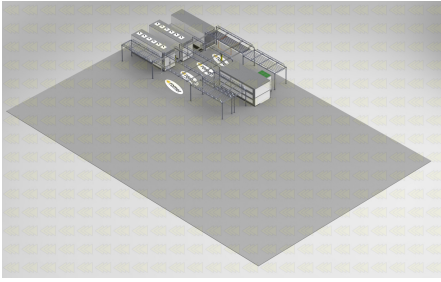
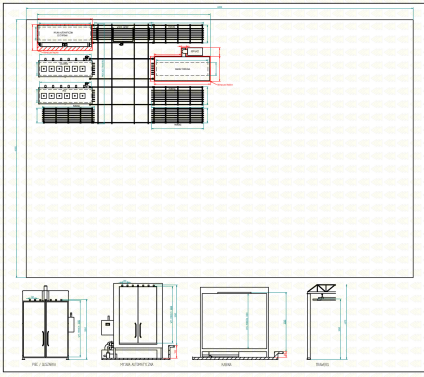

### 4120-2

**Maksimal lakkert detalj:** W1800 D7800mm

**Hallmål:** 60 000 x 40 000 mm

**Overflateforbehandling:** 2-trinns automatisk bilvask

**Tørking etter overflatebehandling:** 6-soners tørketrommel

**Manuell maling:** Gjennomgående tunnelhytte KPT1

**Polymerisasjon:** 6-soners ovn

**Transportsystem: Manuell Topp**

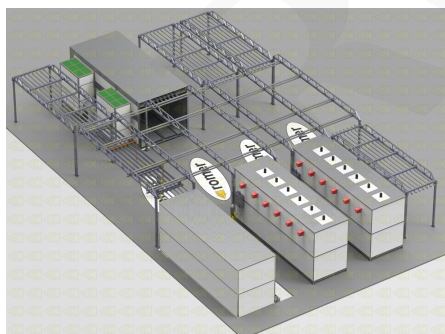
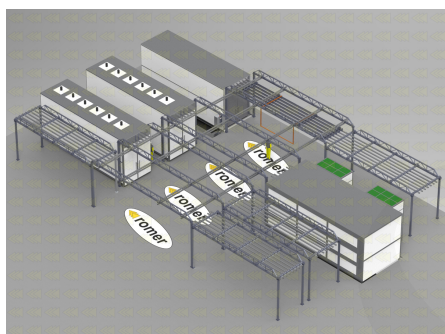
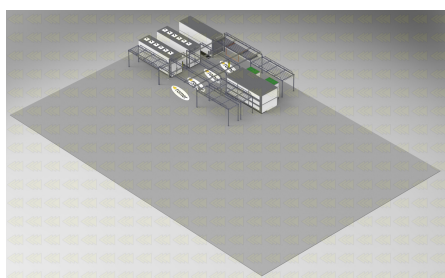
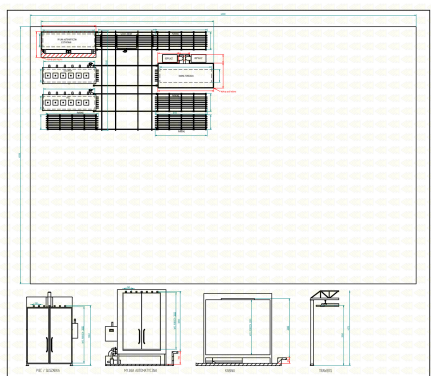

## 9994

**Maksimal lakkert detalj:** W1800 D7800mm

**Hallmål:** 25 000 x 24 800 mm

**Overflateforbehandling:** 2-trinns automatisk bilvask

**Tørking etter overflatebehandling og polymerisering:** 2-soners ovn-tørker

**Manuell maling:** Gjennomgående tunnelhytte KPT1

**Transportsystem: Manuell Topp**

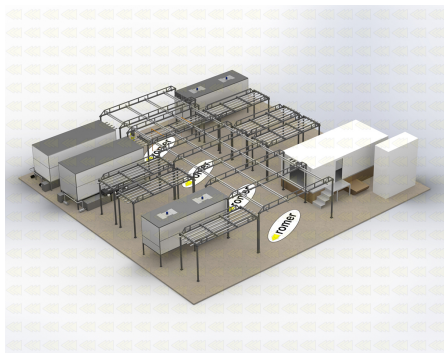
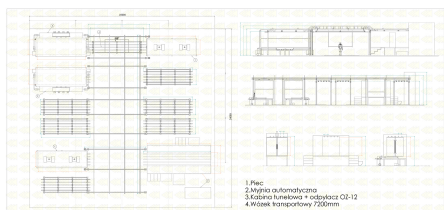

ROMER