

Manuell med traverser

5726

Maksimal lakkert detalj: B1000 D11800mm

Hallmål: 27 150 x 15 100 mm

Overflateforbehandling: 3-trinns automatisk bilvask

Tørking etter overflatebehandling og polymerisering: 4-soners ovn-tørker

Manuell maling: To-seters gjennomgangskabin

Transportsystem: Manuell Topp

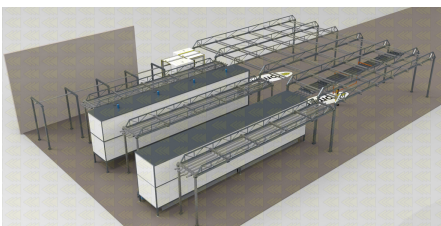
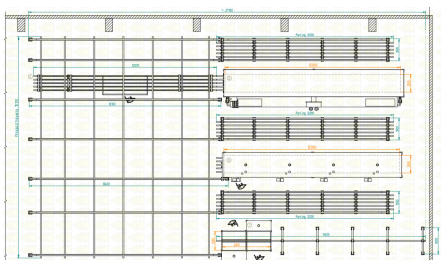

5552

Maksimal lakkert detalj: B1000 D3000mm

Hallmål: 4.500x12.300 mm

Polymerisasjon: 1 sone ovn

Manuell maling: Drosje åpen

Transportsystem: Manuell Topp

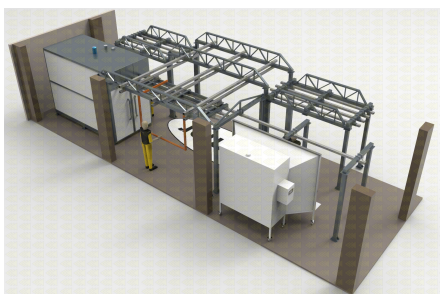
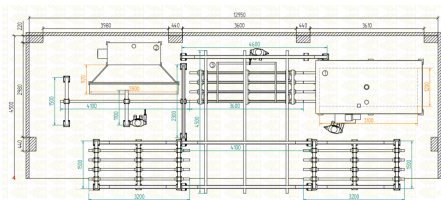

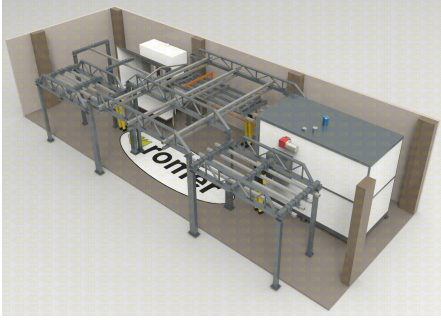

5874

Maksimal lakkert detalj: W1000 D8800mm

Hallmål: 7.400x25.500 mm

Overflateforbehandling: 3-trinns automatisk bilvask

Tørking etter overflatebehandling og polymerisering: 1 sone tørketrommel

Polymerisasjon: 1 sone ovn

Manuell maling: To-seters gjennomgangskabin

Transportsystem: Manuell Topp

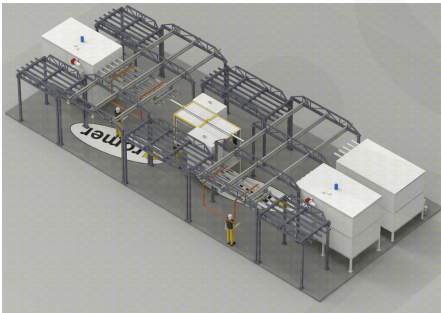
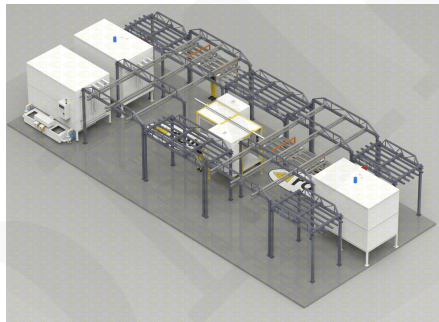
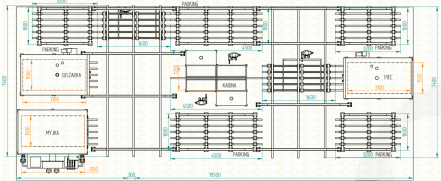

3547-3

Maksimal lakkert detalj: B1300 D3000mm

Hallmål: 14 000 x 24 000 mm

Tørking etter overflatebehandling og polymerisering: 3-soners ovn-tørker

Manuell maling: To-seters gjennomgangskabin

Transportsystem: Manuell Topp

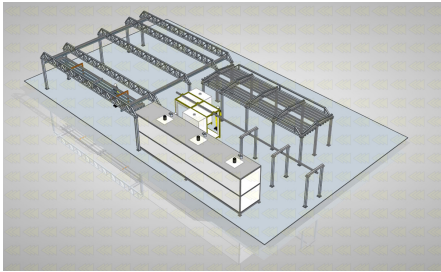
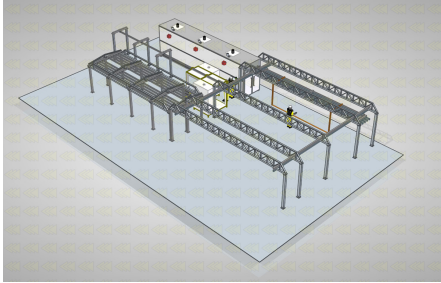
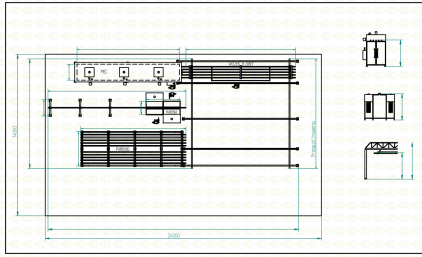

5878

Maksimal lakkert detalj: B1300 D2800mm

Hallmål: 10 500 x 14 200 mm

Overflateforbehandling: 3-trinns automatisk bilvask

Tørking etter overflatebehandling og polymerisering: 1 sone tørketrommel

Manuell maling: To-seters gjennomgangskabin

Transportsystem: Manuell Topp

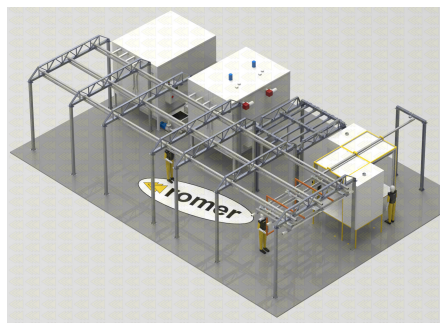
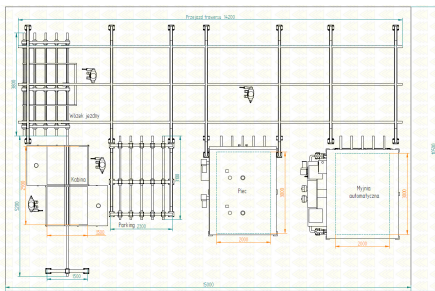

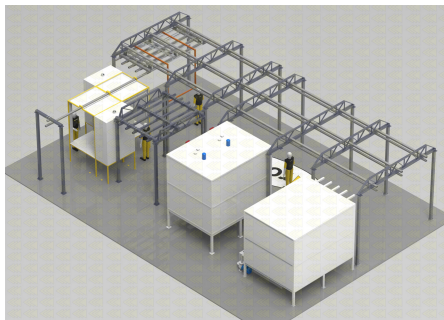

5982

Maksimal lakkert detalj: W1300 D7800mm

Hallmål: 8.000x20.000mm

Manuell maling: To-seters gjennomgangskabin

Polymerisasjon: 3-soners ovn

Transportsystem: Manuell Topp

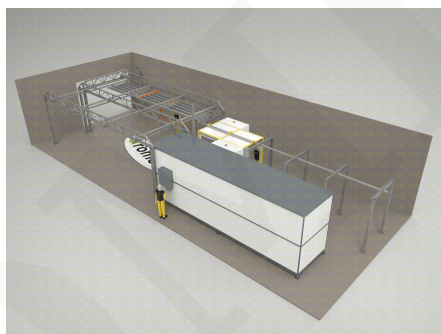
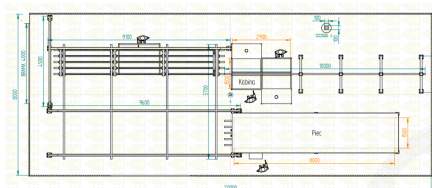

6133

Maksimal lakkert detalj: W1000 D3200mm

Hallmål: 20 400 x 10 000 mm

Overflateforbehandling: 3-trinns automatisk bilvask

Tørking etter overflatebehandling og polymerisering: 1 sone ovn-tørker

Manuell maling: To-seters gjennomgangskabin

Transportsystem: Manuell Topp

ROMER - Producent wysokiej jakości lakierni proszkowych

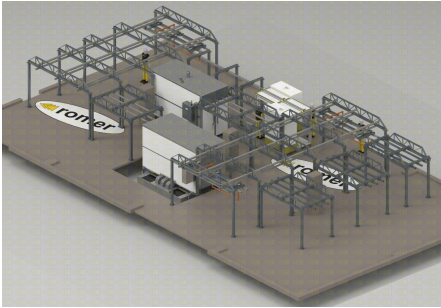
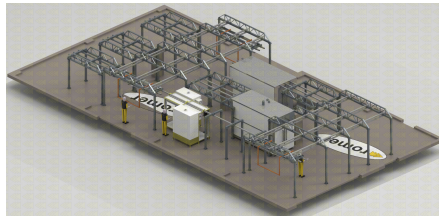
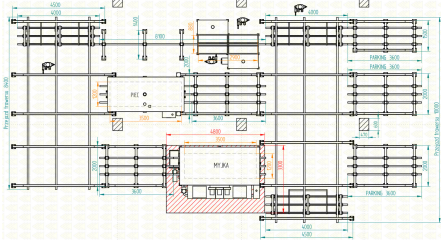

6381

Maksimal lakkert detalj: W1300 D6200mm

Hallmål: 14 300 x 15 500 mm

Overflateforbehandling: Manuell bilvask

Tørking etter overflatebehandling og polymerisering: 3-soners ovn-tørker

Manuell maling: To-seters gjennomgangskabin

Transportsystem: Manuell Topp

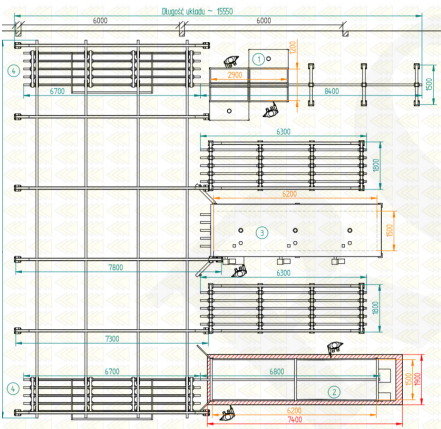

6691

Maksimal lakkert detalj: W1800 D6800mm

Hallmål: 23 300 x 20 200 mm

Overflateforbehandling: 3-trinns automatisk bilvask

Tørking etter overflatebehandling: 4-soners tørketrommel

Manuell maling (lange løp): To-seters gjennomgangskabin

Manuell maling (kort serie): Drosje åpen

Polymerisasjon: 4-soners ovn

Transportsystem: Manuell Topp

ROMER - Producent wysokiej jakości lakierni proszkowych

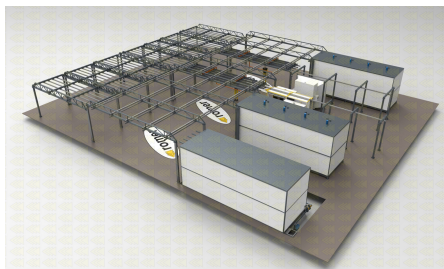
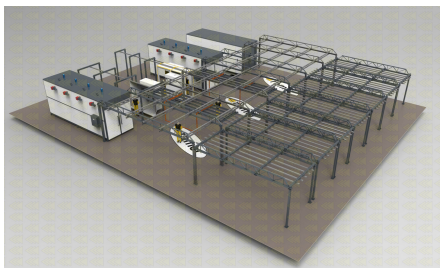
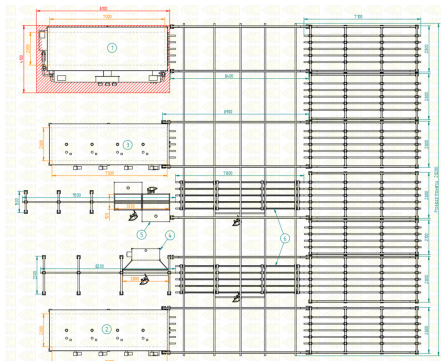

6809

Maksimal lakkert detalj: B1300 D2800mm

Hallmål: 11 600 x 6 700 mm

Overflateforbehandling: Manuell høytrykkspyler MS3015

Tørking etter overflatebehandling og polymerisering: 1 sone ovn-tørker SL / SW

Manuell maling: Enkel arbeidsstasjon gjennomgangskabin KPP-2

Transportsystem: Manuell øvre TR

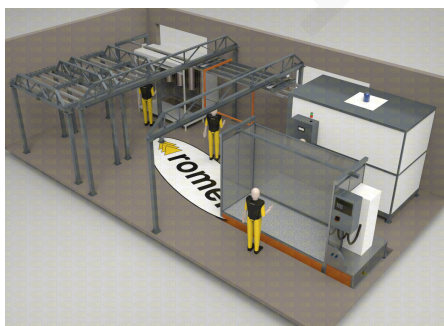
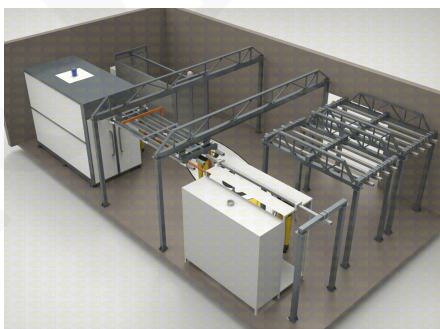
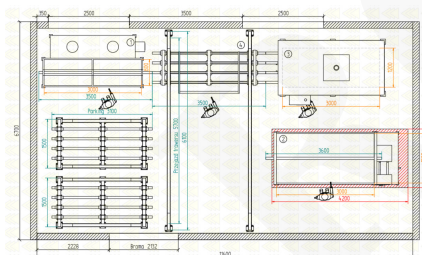

7039

Maksimal lakkert detalj: W1300 D6800mm

Hallmål: 24 300 x 14 700 mm

ROMER - Producent wysokiej jakości lakierni proszkowych

Overflateforbehandling: 5-trinns automatisk bilvask

Tørking etter overflatebehandling og polymerisering: 4-soners ovn-tørker

Manuell maling: Gjennomgående tunnelhytte KPT1

Transportsystem: Manuell øvre TR

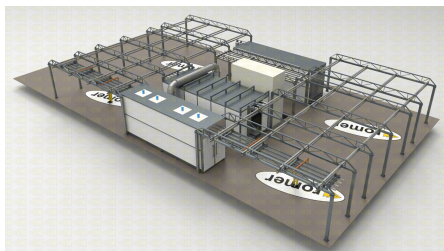
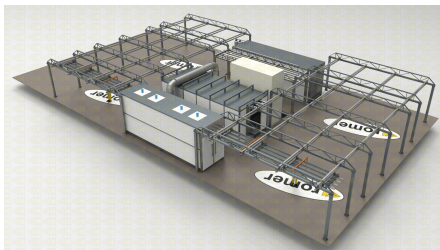
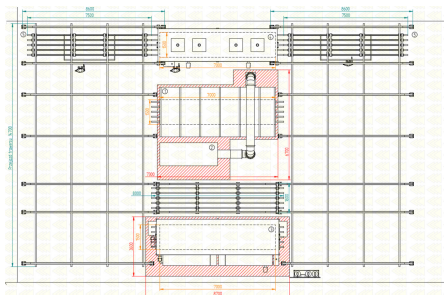

3151

Maksimal lakkert detalj: W1300 D3800mm

Hallmål: 18 800 x 30 900 mm

Overflateforbehandling: 3-trinns automatisk bilvask

Tørking etter overflatebehandling: 1 sone tørketrommel

Manuell maling: To-seters gjennomgangskabin

Polymerisasjon: 1 sone ovn

Transportsystem: Manuell Topp

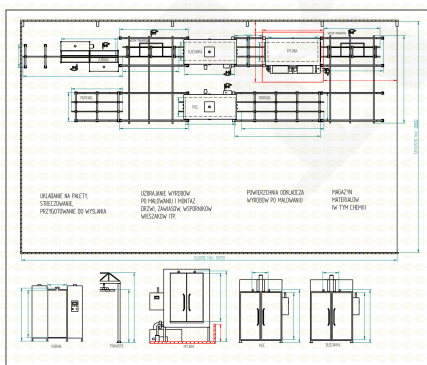

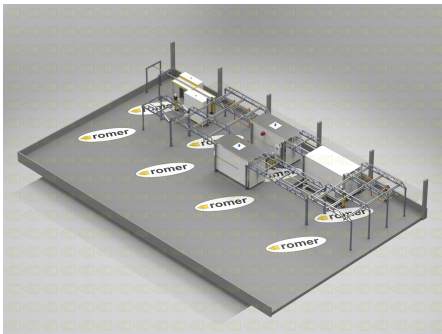
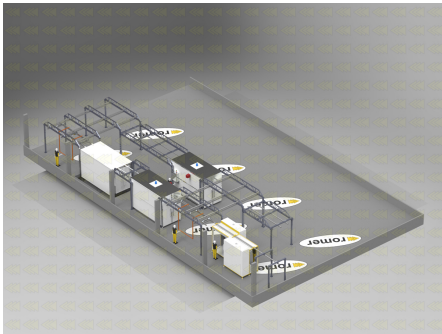

3547-1

Maksimal lakkert detalj: W1000 D8800mm

Hallmål: 14.000x24.000mm

Overflateforbehandling: 3-trinns automatisk bilvask

Tørking etter overflatebehandling og polymerisering: 3-soners ovn-tørker

Manuell maling: To-seters gjennomgangskabin

Transportsystem: Manuell øvre TR

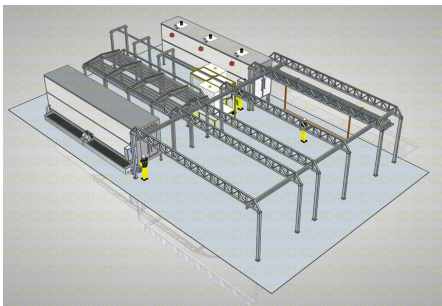
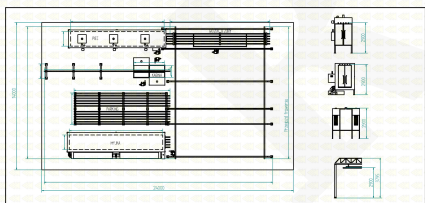

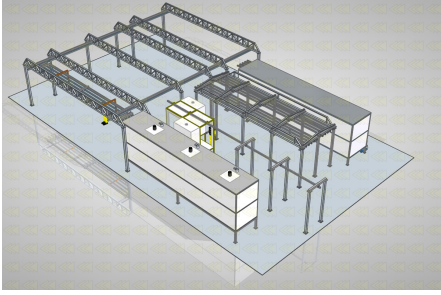

3547-2

Maksimal lakkert detalj: W1000 D8800mm

Hallmål: 14.000x24.000mm

Overflateforbehandling: 3-trinns automatisk bilvask

Tørking etter overflatebehandling og polymerisering: 3-soners ovn-tørker

Manuell maling: To-seters gjennomgangskabin

Transportsystem: Manuell øvre TR

